

COVINGTON

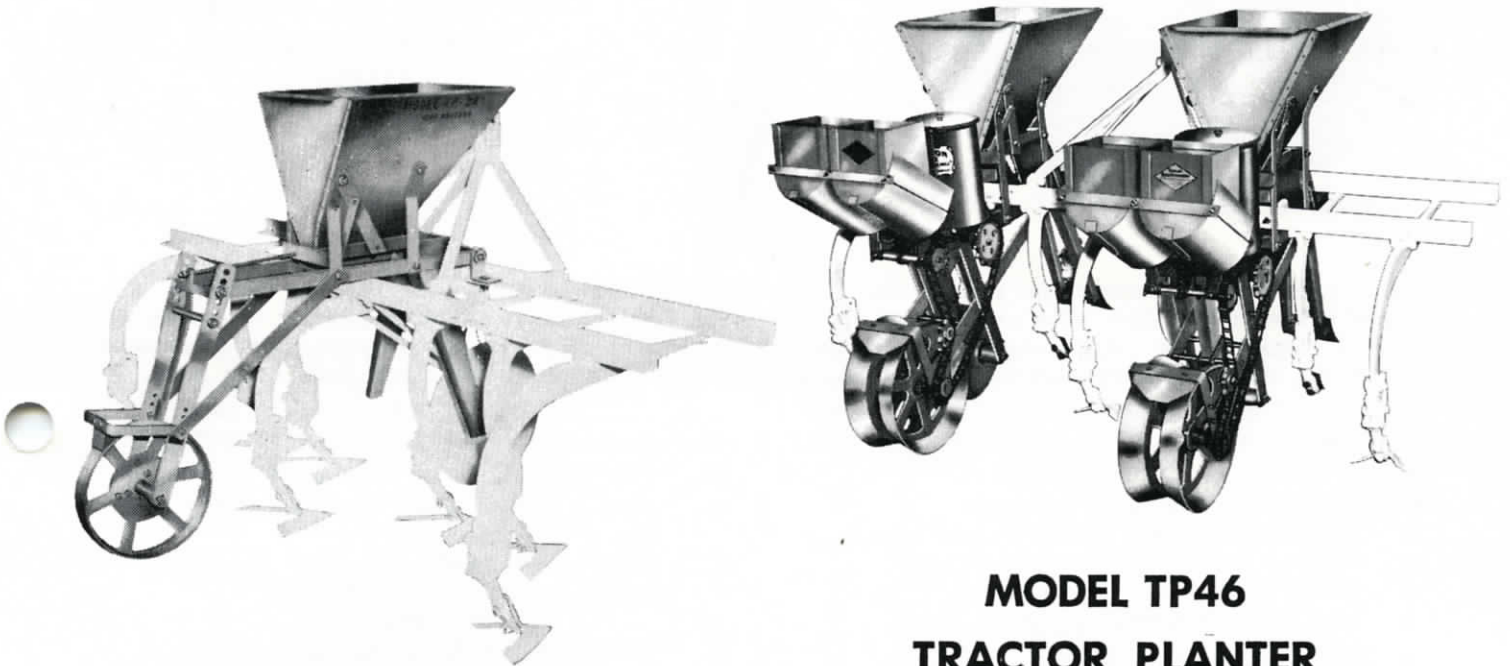

**MODEL TP3A & TP6A
SIDE DRESSER**

**MODEL TP46
TRACTOR PLANTER**



CONTENTS	
PAGE	
2	PLANTER WITH DROPPING SHAFT
3	PLANTER WITH SINGLE GRAIN ATTACHMENT
4	PLATES AND ACCESSORIES FOR MAIN HOPPER BOTTOM (TP500) MAIN HOPPER BOTTOM (TP500A)
5	STIRRING SHAFT ASSEMBLY (TP40) DROPPING SHAFT ASSEMBLY (TP44)
6	PLATES FOR THE SINGLE GRAIN ATTACHMENT SINGLE GRAIN ATTACHMENT BOTTOM (C900A)
7	SINGLE GRAIN ATTACHMENT SHAFT ASSEMBLY (TP91) PRESSER WHEEL
8	12" OPENING DISC ASSEMBLY (1963-) 12" OPENING DISC ASSEMBLY (BEFORE 1963)
9	MISCELLANEOUS — SHOVEL, CULTIVATOR POINT, ETC.
10	SIDE DRESSER — MODEL TP3A AND TP6A
11	NOTES

COVINGTON PLANTER CO., Inc.

ALBANY, GA. 31702

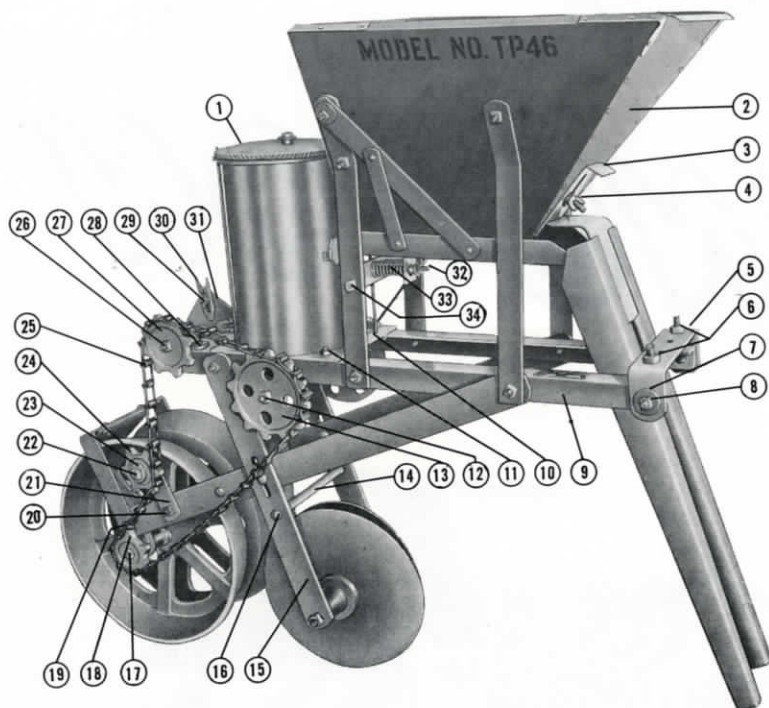

MODEL NO. TP46 TRACTOR PLANTER

WITH DROPPING SHAFT ASSEMBLY

A tractor mounted combination planter and fertilizer distributor for drilling seeds between two equal but separate streams of fertilizer. The planter uses the original hill-drop principle of cotton planting developed by Mr. W. F. Covington, Sr. Replacement of the cotton dropping attachment by an inclined-plate grain attachment converts the planter to a versatile unit for drilling corn, grain, peanuts, peas, beans and many other seeds.

Item No.	Cov. No.	Description	Item No.	Cov. No.	Description
1	TP36A	COVER, Main Seed Can	20	BC-9	BOLT, 3/8" x 1" Carriage with
2	TP86FA	BOX END, Front Fertilizer (Metal)		HN4	NUT, 3/8" Hex
3	TP85	GATE, Fertilizer Box Cut-Off	21	TP61	BRACKET, Steel Idler (Prior 1967)
4	TP84A	BOLT, 3/8" x 3/4" Hex Hd.		TP745	BRACKET, Steel Idler —
	WN4	NUT, 3/8" Wing and			Short Slotted (1967-)
	FW4	WASHER, 3/8" Flat	22	TP61A	BOLT, 3/8" x 1 3/4" Carriage with
5	TP68	YOKE, Front Pull		HN4	NUT, 3/8" Hex
6	BC-13	BOLT, 7/16" x 1 1/4" Carriage with	23	TP62	WASHER, 13/32" x 1 5/8" Flat
	HN5	NUT, 7/16" Hex	24	C864	SPROCKET, 6 Tooth Idler
7	TP33	BEARING, Pull Yoke	25	33	CHAIN, No. 33 Steel Sprocket — 1 foot
8	BC-10	BOLT, 3/8" x 1 1/4" Carriage with	26	TP43	SHAFT, Dropping — 7/16" x 10" with
	HN4	NUT, 3/8" Hex		HN4	NUT, 3/8" Hex
9	TP35R	FRAME, Main Angle — Right			COTTER PIN, 3/16" x 1"; and
10	TP500	BOTTOM, Main Hopper		TP48	WASHER, 15/32" Sq. Hole, Flat
11	BC-3	BOLT, 5/16" x 3/4" Carriage with	27	C818	SPROCKET, 8 Tooth
	HN3	NUT, 5/16" Hex	28	TP1	BEARING, Dropping, Stirring and
12	TP38	SHAFT, Stirring—7/16" Sq. x 10 3/4" with			G.A. Shaft
	HN4	NUT, 3/8" Hex	29	BC-1	BOLT, 1/4" x 3/4" Carriage with
		COTTER PIN 3/16" x 1"; and		FW2	WASHER, 1/4" Flat and
	TP48	WASHER, 15/32" Sq. Hole, Flat		WN2	NUT, 1/4" Wing
13	TP7	SPROCKET, 12 Tooth	30	C811	FINGER, Dropping
14	TP51B	SPACER, Opening Disc Brace —	31	C809	PLATE, Steel Finger
		3/8" x 8" Pipe	32	TP81A	BOLT, 5/16" x 3 3/4" Carriage with
15	TP50R	BRACE, Opening Disc — Right		HN3	NUT, 5/16" Hex and
16	TP51A	BOLT, 3/8" x 9 1/4" Carriage with		FW3	WASHER, 5/16" Flat and
	HN4	NUT, 3/8" Hex		LW3	WASHER, 5/16" Lock
17	BM-1	BOLT, 3/8" x 1" Hex Hd.	33	TP78	SPRING, No. 2 Vibrating
18	C817	SPROCKET, 6 Tooth	34	BM-4	BOLT, 7/16" x 1" Hex Hd. with
19	BM-2	BOLT, 3/8" x 1 1/4" Hex Hd. with		HN5	NUT, 7/16" Hex
	HN4	NUT, 3/8" Hex		TP87A	BRACE, Box Steady (not shown)

MODEL NO. TP46 TRACTOR PLANTER

WITH SINGLE GRAIN ATTACHMENT

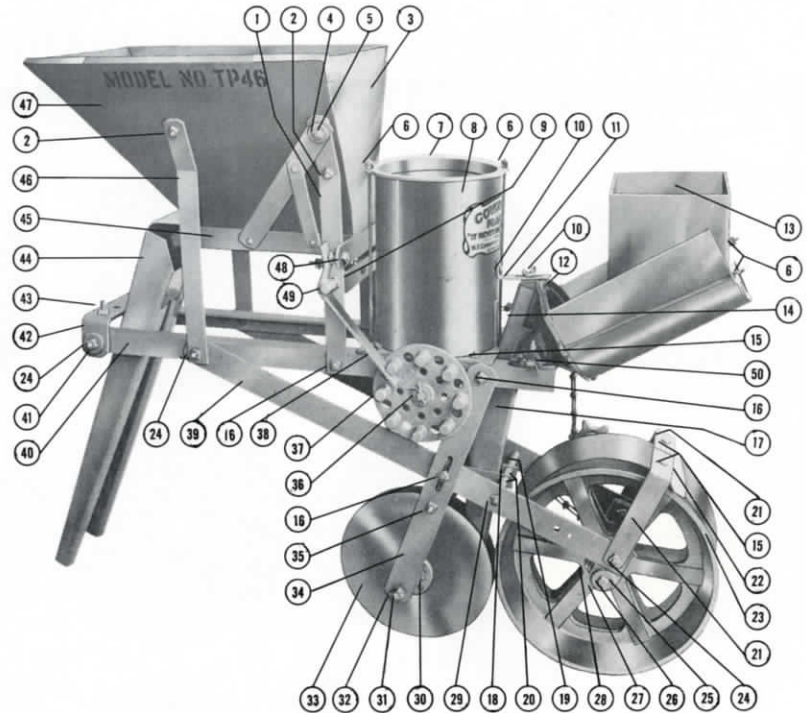

Item No.	Cov. No.	Description	Item No.	Cov. No.	Description
1	TP88	BRACE, Rear Fertilizer Box	26	BM-1	BOLT, 3/8" x 1" Hex Head
2	BC-5	BOLT, 5/16" x 1 1/2" Carriage with HN3 NUT, 5/16" Hex	27	TP62	WASHER, 13/32" x 1 5/8" Flat
3	TP86RA	BOX END, Rear Fertilizer (Metal)	28	TP64	FITTING, 1/8" Straight Lubrication
4	BC-6	BOLT, 5/16" x 1 3/4" Carriage with HN3 NUT, 5/16" Hex	29	TP52A	BOLT, 3/8" x 8 1/2" Carriage with HN4 NUT, 3/8" Hex
5	TP34	BUSHING, Vibrating Pan	30	TP503	BEARING, Opening Disc (Before 1963)
6	TP65	ROD, Can—1/4" x 12 1/2" Carriage with WN2 NUT, 1/4" Wing	31	SN-6	NUT, 1/2" Hex
7	C857	RING, Main Seed Can	32	TP49B	AXLE, Disc Bearing—9/16" Sq. x 10"
8	TP36	CAN, Main Seed—Round	33	TP19	DISC, 12" Opening
9	TP80	YOKE, Vibrating Pan	34	TP50L	BRACE, Opening Disc — Left
10	BC-3	BOLT, 5/16" x 3/4" Carriage with WN3 NUT, 5/16" Wing and FW4 WASHER, 3/8" Flat	35	TP51A	BOLT, 3/8" x 9 1/4" Carriage with HN4 NUT, 3/8" Hex
11	TP93	HOLDER, Grain Attachment Bracket	36	TP38	SHAFT, Stirring—7/16" Sq. x 10 3/4" with HN4 NUT, 3/8" Hex
12	C900	BOTTOM, Grain Attachment		TP48	COTTER PIN, 3/16" x 1"; and WASHER, 15/32" Square Hole, Flat
13	TP94	CAN, Grain Attachment Seed	37	TP2	VIBRATOR, Distributor Drive
14	TP95	SPOUT, Grain Attachment Seed	38	TP82A	ARM, Vibrating (Welded Assembly)
15	BC-3	BOLT, 5/16" x 3/4" Carriage with HN3 NUT, 5/16" Hex	39	TP59	ARM, Presser Wheel Pull
16	BC-9	BOLT, 3/8" x 1" Carriage with HN4 NUT, 3/8" Hex	40	TP35L	FRAME, Main Angle — Left
17	TP66	SPOUT, Main Seed (for Single Gr. Att.)	41	TP33	BEARING, Pull Yoke
	TP618	SPOUT, Main Seed (for Duplex Gr. Att.)	42	TP68	YOKE, Front Pull
18	TP52C	SPACER, Main Seed Spout Support — 3/8" x 1 1/2" Pipe	43	BC-13	BOLT, 7/16" x 1 1/4" Carriage with HN5 NUT, 7/16" Hex
19	TP52B	SPACER, Main Seed Spout Support — 3/8" x 2 7/8" Pipe	44	TP77	SPOUT, Fertilizer
20	TP619	BRACKET, Main Seed Spout	45	TP79A	PAN, Vibrating (Riveted Assembly)
21	TP56	BRACE, Presser Wheel Scrape — Pair	46	TP87	BRACE, Front Fertilizer Box
22	TP55	SCRAPE, Presser Wheel	47	TP83A	BOX, Fertilizer — Large
23	C845	WHEEL HALF, Presser	48	BM-1	BOLT, 3/8" x 1" Hex Head with HN4 NUT, 3/8" Hex
24	BC-10	BOLT, 3/8" x 1 1/4" Carriage with HN4 NUT, 3/8" Hex	49	BM-5	BOLT, 7/16" x 2 1/2" Hex Head with HN5 NUT, 7/16" Hex (2)
25	TP14	BEARING, Presser Wheel Shaft	50	TP1	BEARING, Dropping, Stirring and G.A. Shaft
				TP87A	BRACE, Box Steady (not shown)

PLATES AND ACCESSORIES FOR MAIN HOPPER BOTTOM (TP500)

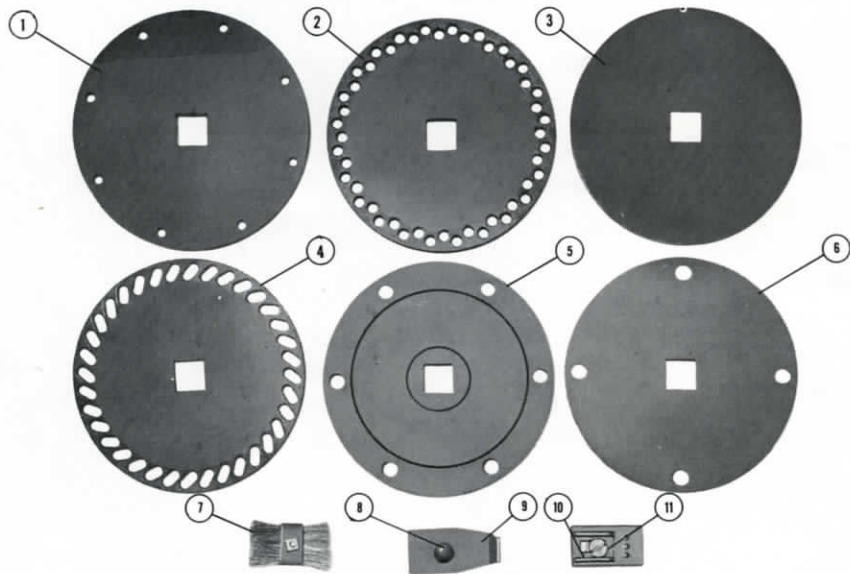

No. Item No.	Cov. No.	Description	Item No.	Cov. No.	Description
1	C828	PLATE, 8 Hole Sorghum	8		BOLT, 5/16" x 3/4" Carriage with WASHER, 5/16" Flat and NUT, 5/16" Wing CUT-OFF, Vegetable Drilling CONVEYOR, Vegetable Drilling SCREW 5/16" x 1" F. H. Machine with NUT, 5/16" Hex
2	C867	PLATE, 48 Hole Soy Bean			
3	C870	PLATE, Blank			
4	TP509	PLATE, 36 Hole Snap Bean	9	TP495	
5	TP508	PLATE, 6 Hole Delinted Cottonseed	10		
6	TP507	PLATE, 4 Hole Velvet Bean	11		
7	C94	BRUSH, Cut-Off			

} ATTACHMENT,
Vegetable Drilling

MAIN HOPPER BOTTOM (TP500A)

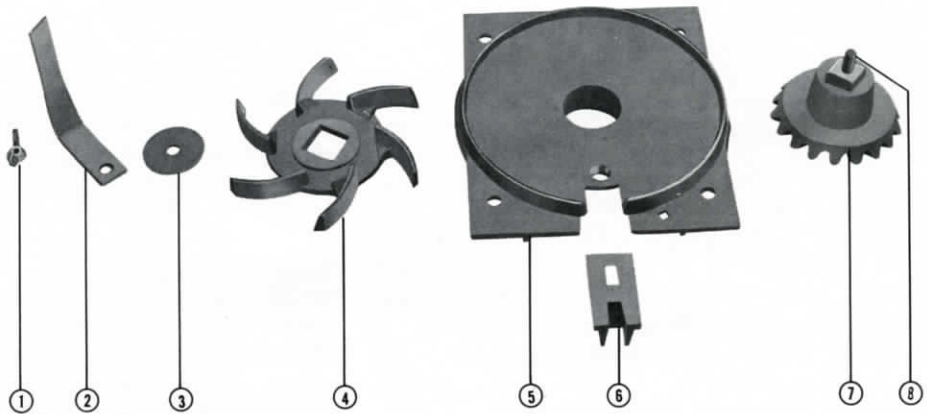

Item No.	Cov. No.	Description	Item No.	Cov. No.	Description
1	WN4	NUT, 3/8" Wing	6	C802	CONVEYOR, Cotton Seed with
2	TP37	AGITATOR, Seed		BS-4	BOLT, 5/16" x 1" Stove (not shown) and
3	TP63	WASHER, 13/32" x 2" Flat		HN3	NUT, 5/16" Hex (not shown)
4	C853	STIRRER, Cotton Seed	7	TP501	GEAR, 18 Tooth Plate
5	TP500	BOTTOM, Main Hopper	8	BM-2	BOLT, 3/8" x 1 1/4" Hex Head

STIRRING SHAFT ASSEMBLY (TP40)

(PLUS TP53 AND 5/16" CARRIAGE BOLTS)

Item No.	Cov. No.	Description
1	TP7	SPROCKET, 12 Tooth
2	TP32	BUSHING, Sprocket
3	BC-7	BOLT, 5/16" x 2 1/4" Carriage
4	HN3	NUT, 5/16" Hex
5	TP53	SUPPORT, Stirring Shaft Pipe — 1/4" x 1-7/16"
6	TP42	BUSHING, Stirring Shaft Pipe Space — 1/2" x 5 5/8"
7	TP1	BEARING, Dropping, Stirring and G.A. Shaft
8	TP2	VIBRATOR, Distributor Drive
9	TP38	SHAFT, Stirring—7/16" Sq. x 10 3/4", with —
	TP48	WASHER, 15/32" Sq. Hole, Flat (hid.) & HN4
	HN4	NUT, 3/8" Hex (hidden)
10	TP64	FITTING, 1/8" Straight Lubrication
11	TP502	GEAR, 9 Tooth Pinion
12	TP41	BUSHING Stirring Shaft Pipe Space — 1/2" x 1-15/16"

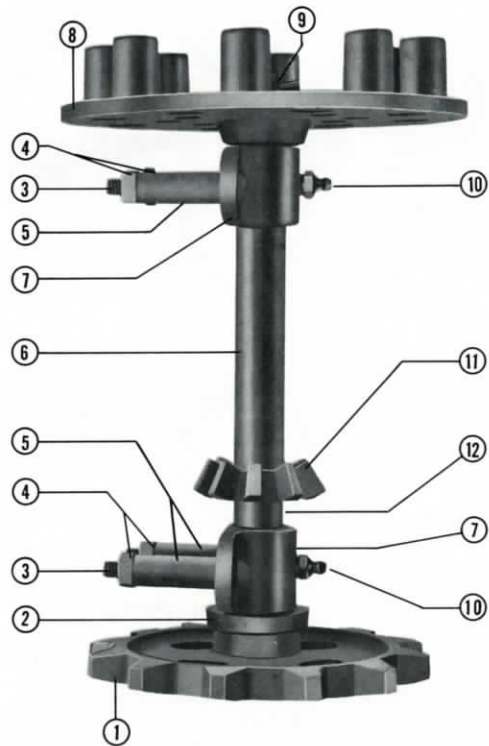

DROPPING SHAFT ASSEMBLY (TP44)

Item No.	Cov. No.	Description
1	—	COTTER PIN, 3/16" x 1"
2	TP1	BEARING, Dropping, Stirring and G.A. Shaft
3	C811	FINGER, Dropping
4	FW2	WASHER, 1/4" Flat
5	WN-2	NUT, 1/4" Wing
6	BC-1	BOLT, 1/4" x 3/4" Carriage
7	TP64	FITTING, 1/8" Straight Lubrication
8	C818	SPROCKET, 8 Tooth
9	HN4	NUT, 3/8" Hex
10	TP43	SHAFT, Dropping — 7/16" Sq. x 10"
11	TP32	BUSHING, Sprocket
12	TP47	BUSHING, Dropping Shaft Pipe Space - 1/2" x 4-1/16"
13	C809	PLATE, Steel Finger
14	TP46	BUSHING, Dropping Shaft Pipe Space - 1/2" x 3 3/8"
15	TP48	WASHER, 15/32" Square Hole Flat

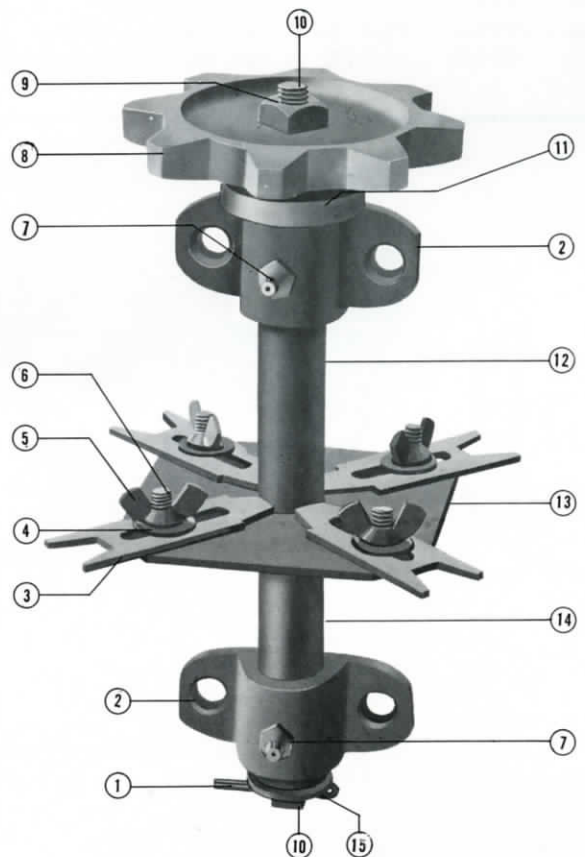

PLATES FOR THE SINGLE GRAIN ATTACHMENT

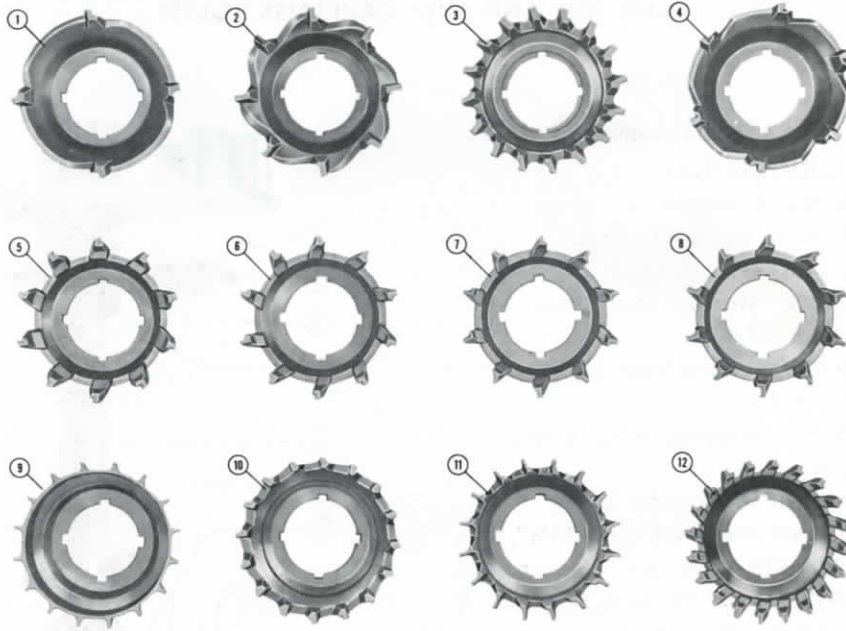

Item No.	Cov. No.	Description
1	C904	PLATE, 4 Cell Corn
2	C905	PLATE, 8 Cell Peanut
3	C906	PLATE, 16 Cell Peanut
4	C907	PLATE, 6 Cell Corn
5	TP525	PLATE, 10 Cell Corn—Medium Flat
6	TP527	PLATE, 10 Cell Corn—Small Round
7	TP528	PLATE, 10 Cell Corn—Medium Round
8	TP529	PLATE, 10 Cell Corn—Large Round
9	TP530	PLATE, 16 Cell Soy Bean
10	TP531	PLATE, 16 Cell Sorghum
11	TP532	PLATE, 16 Cell Peanut—Large
12	TP533	PLATE, 20 Cell Delinted Cottonseed

Item No.	Cov. No.	Description
13	TP534	PLATE, 10 Cell Corn—Single Cross (not shown)
14	TP537	PLATE, 16 Cell Peanut—Jumbo (not shown)
15	TP538	PLATE, 10 Cell Corn—Large Flat (not shown)
16	TP539	PLATE, 28 Cell Peanut—Small (not shown)
17	TP540	PLATE, 2 Cell Watermelon or V. Bean (not shown)
18	TP548	PLATE, 37 Cell Soy Bean (not shown)

SINGLE GRAIN ATTACHMENT BOTTOM (C900A)

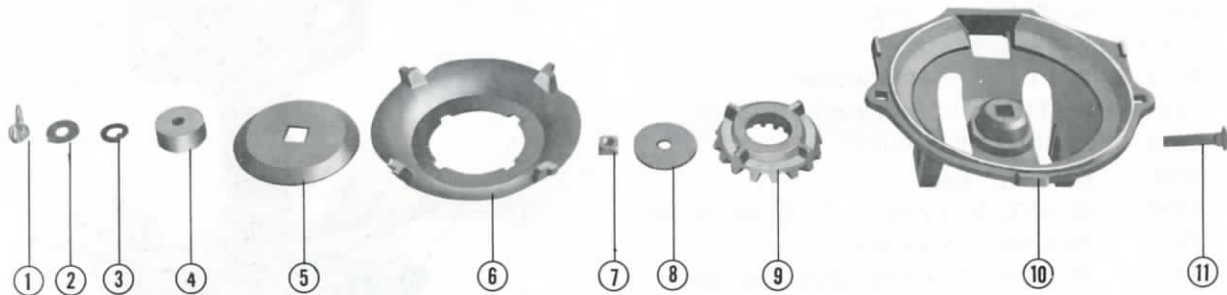

Item No.	Cov. No.	Description
1	WN-4	NUT, 3/8" Wing
2	FW4	WASHER, 3/8" Flat
3	LW6	WASHER, 1/2" Lock
4	C908	CONE, Adjustment
5	TP910	WASHER, Grain Attachment Plate
6	C904	PLATE, 4 Cell Corn

Item No.	Cov. No.	Description
7	HN4	NUT, 3/8" Hex
8	TP63	WASHER, 13/32" x 2" Flat
9	C901	GEAR, 16 Tooth Plate
10	C900	BOTTOM, Grain Attachment
11	TP61A	BOLT, 3/8" x 1 3/4" Carriage

SINGLE GRAIN ATTACHMENT SHAFT ASSEMBLY (TP91)

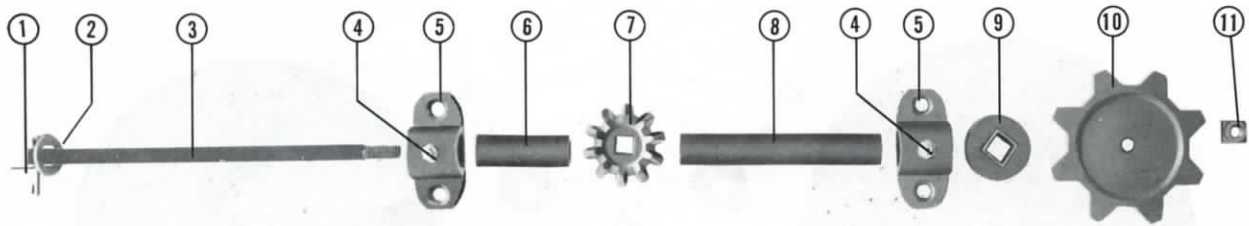

Item No.	Cov. No.	Description	Item No.	Cov. No.	Description
1	—	COTTER PIN, 3/16" x 1"	7	C804	GEAR, 10 Tooth Pinion
2	TP48	WASHER, 15/32" Square Hole, Flat	8	TP91A	BUSHING, Grain Attach. Pipe Space — (1/2" x 5-5/16")
3	TP89	SHAFT, Grain Attach.—7/16" Sq. x 10"	9	TP32	BUSHING, Sprocket
4	TP64	FITTING, 1/8" Straight Lubrication	10	C818	SPROCKET, 8 Tooth
5	TP1	BEARING, Dropping, Stirring and G.A. Shaft	11	HN4	NUT, 3/8" Hex
6	TP91B	BUSHING, Grain Attach. Pipe Space — (1/2" x 2 1/2")			

PRESSER WHEEL

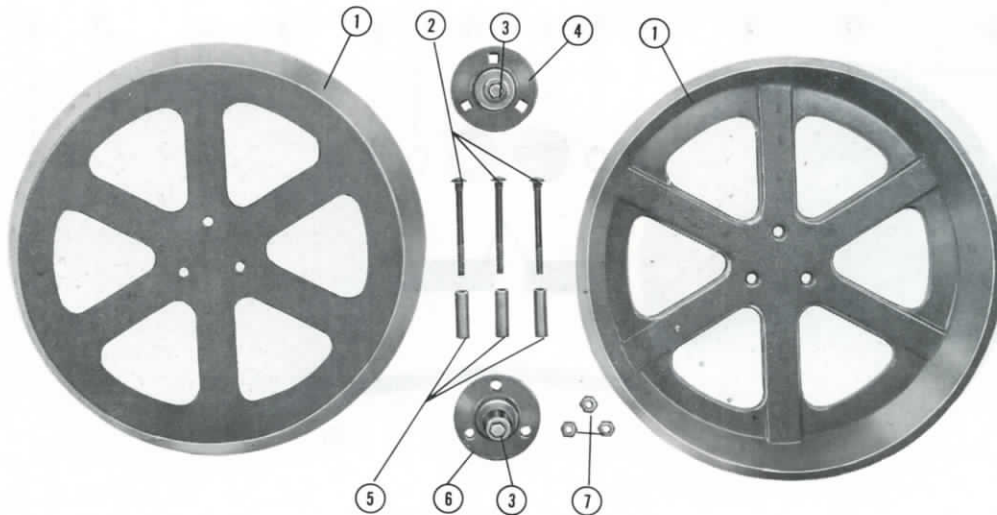

Item No.	Cov. No.	Description	Item No.	Cov. No.	Description
1	C845	WHEEL HALF, Presser	5	TP57	SPACER, Presser Wheel Pipe — 1/4" x 1 3/4"
2	BC-8	BOLT, 5/16" x 3 1/2" Carriage	6	TP31	SHAFT, Presser Wheel — Plain End
3	BM-1	BOLT, 3/8" x 1" Hex Head	7	HN3	NUT, 5/16" Hex
4	TP30	SHAFT, Presser Wheel—Sprocket End			

12" OPENING DISC ASSEMBLY (1963-)

TP692 LESS BRACES (TP50) AND SPACER (TP51)

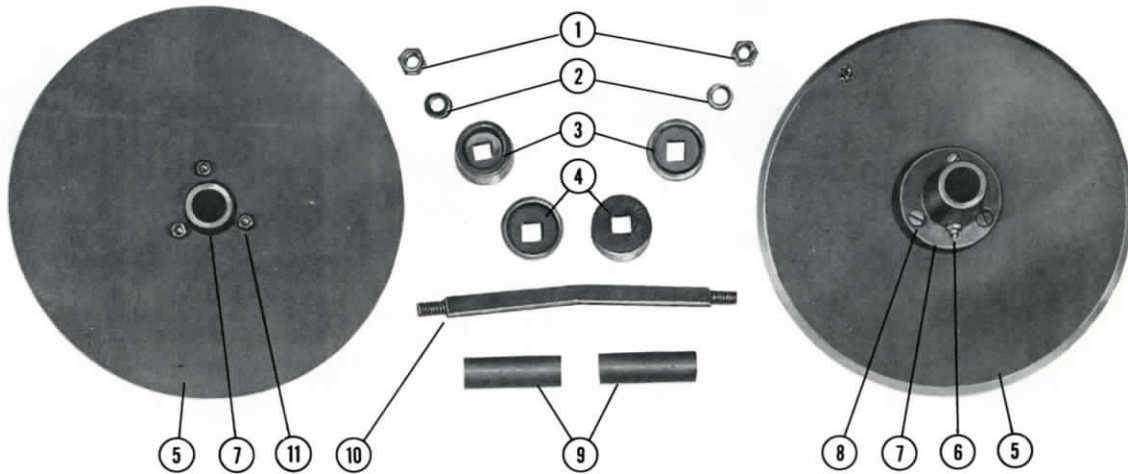

Item No.	Cov. No.	Description	Item No.	Cov. No.	Description
1	HN6	NUT, 1/2" Hex	7	TP513	BEARING, Disc (1963-)
2	LW6	WASHER, 1/2" Lock	8	MS1	SCREW, 1/4" x 3/4" F. H. Machine
3	TP514	SPACER, Disc Bearing (1963-)	9	TP516	BUSHING, Disc Bearing - 3/4x3-1/8" Pipe
4	TP515	END CAP, Disc Bearing (1963-)	10	TP49B	AXLE, Disc Bearing
5	TP19	DISC, 12" Opening	11	HN2	NUT, 1/4" Hex
6	TP64	FITTING, 1/8" Straight Lubrication			

12" OPENING DISC ASSEMBLY (BEFORE 1963)

TP49 LESS BRACES (TP50) AND SPACER (TP51)

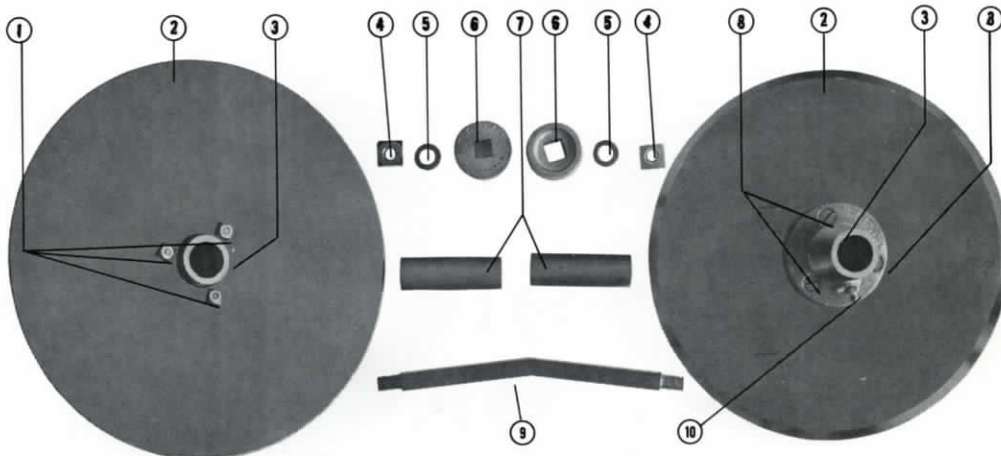

Item No.	Cov. No.	Description	Item No.	Cov. No.	Description
1	HN2	NUT, 1/4" Hex	7	TP49A	BUSHING, Disc Bearing — 3/4" x 3 1/4" Pipe
2	TP19	DISC, 12" Opening	8	MS-1	SCREW, 1/4" x 3/4" F. H. Machine
3	TP503	BEARING, Opening Disc	9	TP49B	AXLE, Disc Bearing
4	HN6	NUT, 1/2" Hex	10	TP64	FITTING, 1/8" Straight Lubrication
5	LW6	WASHER, 1/2" Lock			
6	TP504	SPACER, Opening Disc Bearing			

MODEL NO. TP-3A and MODEL TP-6A SIDE DRESSER

MODEL TP6A SAME AS
MODEL TP3A, EXCEPT,
MODEL TP6A
WITH FIBERGLAS
FERTILIZER BOX

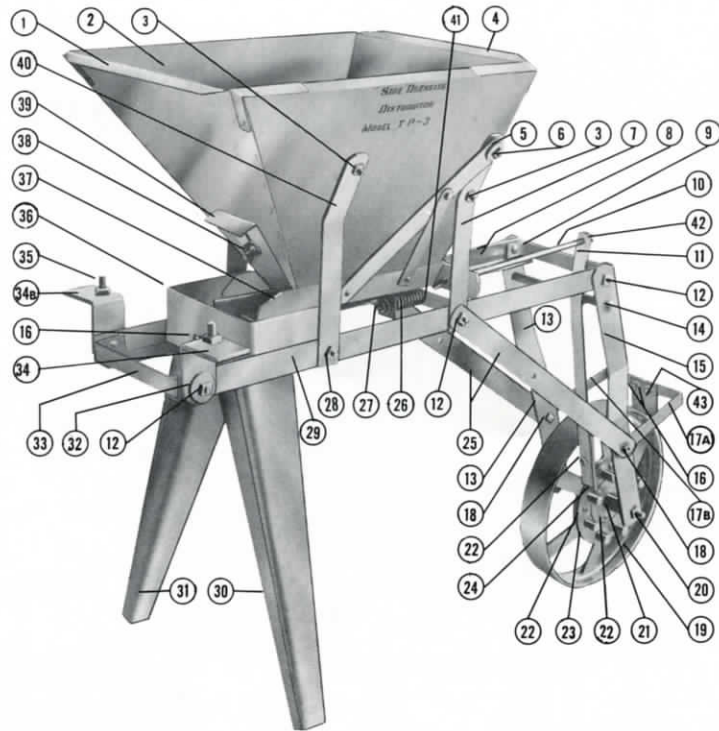

A tractor mounted Side Dressing Distributor for applying fertilizer to two rows at one time during the normal cultivation procedure. The unit can be adjusted to distribute fertilizer at any normal rate per acre and can be used on any normal width rows.

Item No.	Cov. No.	Description	Item No.	Cov. No.	Description
1	TP86FA	BOX END, Front Fertilizer (Metal)	HN3	HN3	NUT, 5/16" Hex
2	SD83A	BOX, Fertilizer, Large	23	D6	VIBRATOR, Drive Wheel
	TP820	BOX, Fertilizer, Fiberglas	24	SD6	ARM, Steel Tappet
3	BC-5	BOLT, 5/16" x 1 1/2" Carriage with	25	SD5	BRACE, Pull Arm Wheel
	HN3	NUT, 5/16" Hex	26	TP78	SPRING, No. 2 Vibrating
4	TP86RA	BOX END, Rear Fertilizer (Metal)	27	TP81A	BOLT, 5/16" x 3 3/4" Carriage with
5	TP34	BUSHING, Vibrating Pan	HN3	HN3	NUT, 5/16" Hex and
6	BC-6	BOLT, 5/16" x 1 3/4" Carriage with	FW3	FW3	WASHER, 5/16" Flat and
	HN3	NUT, 5/16" Hex	LW3	LW3	WASHER, 5/16" Lock
7	SD88	BRACE, Rear Fertilizer Box	28	BC-9	BOLT, 3/8" x 1" Carriage with
8	SD35R	FRAME, Main Angle — Right	HN4	HN4	NUT, 3/8" Hex
9	SD2R	SPACER, Rear Frame (Same as SD80)	29	SD35L	FRAME, Main Angle — Left
10	SD3	ROD, Adjusting — 3/8" x 14 1/2"	30	SD77L	SPOUT, Fertilizer — Left
11	SD7	SUPPORT, Tappet Arm	31	SD77R	SPOUT, Fertilizer — Right
12	BC-10	BOLT, 3/8" x 1 1/4" Carriage with	32	TP33	BEARING, Pull Yoke
	HN4	NUT, 3/8" Hex	33	SD2F	SPACER, Front Frame (Same as SD80)
13	SD4R	STANDARD, Main Wheel — Right	34A	SD68L	YOKE, Front Pull — Left
14	TP51A	BOLT, 3/8" x 9 1/4" Carriage with	34B	SD68R	YOKE, Front Pull — Right
	HN4	NUT, 3/8" Hex	35	BC-13	BOLT, 7/16" x 1 1/4" Carriage with
15	SD4L	STANDARD, Main Wheel — Left	HN5	HN5	NUT, 7/16" Hex
16	BC-3	BOLT, 5/16" x 3/4" Carriage with	36	SD70A	YOKE, Fertilizer Spout
	HN3	NUT, 5/16" Hex	37	SD79A	PAN, Vibrating (Riveted Assembly)
17A	SD56	BRACE, Wheel Scrape — Left	38	TP84A	BOLT, 3/8" x 3/4" Hex Head with
17B	SD56	BRACE, Wheel Scrape — Right	WN4	WN4	NUT, 3/8" Wing and
18	BM-1	BOLT, 3/8" x 1" Hex Head with	FW4	FW4	WASHER, 3/8" Flat
	HN4	NUT, 3/8" Hex	39	TP85	GATE, Fertilizer Box Cut-Off
19	D9	WHEEL, Cast Drive	40	SD87	BRACE, Front Fertilizer Box
20	SD1A	BOLT, 7/16" x 7 1/2" Hex Head with	41	SD80	YOKE, Vibrating Pan
	HN5	NUT 7/16" Hex and	42	HN4	NUT, 3/8" Hex (2)
	SD1B	BUSHING, Pipe (for D7)—Hidden	LW4	LW4	WASHER, 3/8" Lock
21	D7	AXLE, Drive Wheel	43	SD54A	SCRAPE, Wheel
22	BC-4	BOLT, 5/16" x 1" Carriage with	SD19	SD19	BUSHING, Wheel Standard (not shown)



COVINGTON PLANTER CO., Inc.
Post Office Box 2
Albany, Georgia 31702
912-888-2032

THE BAINBRIDGE POST-SEARCHLIGHT, INC.
301 N. Crawford St. — Bainbridge, GA 31717
(912) 246-2827